

NOTES1:

- UL Standard
 1. Rated voltage/current : 300V / 16A
 2. Withstanding voltage : AC1600V/1Min.
 3. Ratings : Use group B,C 300V AC/DC
 Use group D 600V AC/DC

IEC Standard

1. Pollution degree	2	2	3
Overvoltage category	II	III	III
Rate impulse voltage(kV)	6kV	6kV	6kV
Rate voltage(V)	1000V	630V	500V
Rate current(A)	20A		

NOTES2:

1. Dimension shall be interpreted per ASME Y14.5-2009
 2. Pitch : 7.50mm, Poles : N=02~12P
 3. Operating temperature: -40°C~+130°C
 4. Undimensioned tolerances:

Pitch range in mm	Nominal dimension range in mm					
	Over	Over	Over	Over	Over	Over
T0	6	10	10	30	60	100
6	10	24	30	60	100	150
	± 0.15	± 0.20	± 0.30	± 0.30	± 0.50	± 0.70
					± 1.00	± 1.30
						± 2

5. RoHS Compliance

Ordering Information

JL9EDGRC - 750 XX B 0 1

Pitch 750=7.50PH
 No. of pins 2P~15P
 Housing Color
 B=Black
 G=Green
 U=Blue
 R=Red
 V=White
 Y=Yellow
 D=Orange
 E=Grey

Packaging
 0=Pe bag
 A=Tray
 T=Tube

PCB LAYOUT

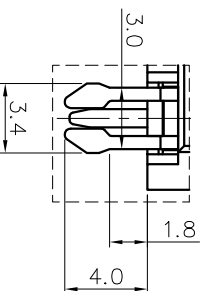
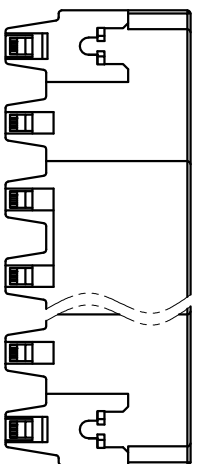
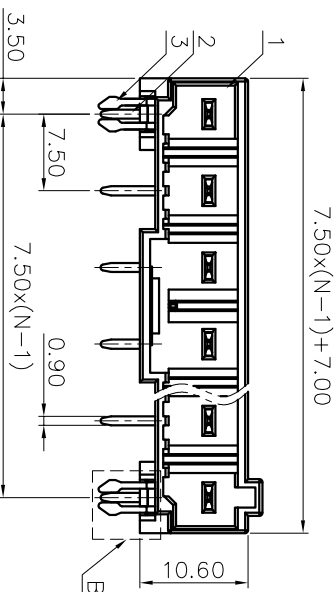
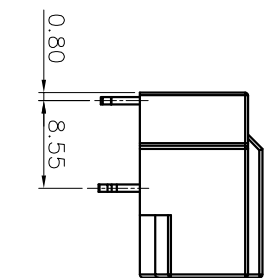
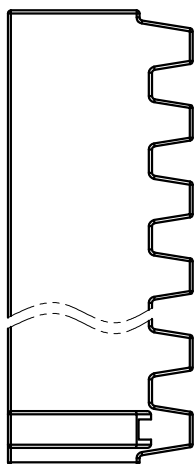
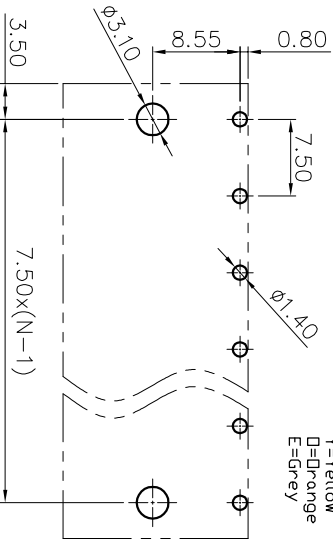

ITEM	NAME OF PART	MATERIAL	NOTES
5	Clamp	Copper alloy	Sn Plated
4	Screw	Steel	M3/Zn Plated
3	Cage	Copper alloy	M3/Ni Plated
2	Spring	Stainless Steel	
1	Housing	PA66	UL94V-0

DRAW	LICHAO LIU	SCALE	FIT		JILIN 东莞市锦凌电子有限公司 DONGGUAN JINLING ELECTRONIC CO., LTD	PART NO.	JL9EDGRC-750XXB01
CHECK	LICHAO LIU	UNIT	mm				
APPROVE	G. Y. L	SIZE	A4				
		SHEET	1/1	TITLE:	JL9EDGRC-7.5公端接线端子台		

REVISION RECORD			
REV	ECN	DESCRIPTION	DATE